

Contour next link
Wireless Blood Glucose Monitoring System

Uses only CONTOUR®NEXT blood glucose test strips

NO CODING

ASCENSIA Diabetes Care

Medtronic

QUICK REFERENCE GUIDE

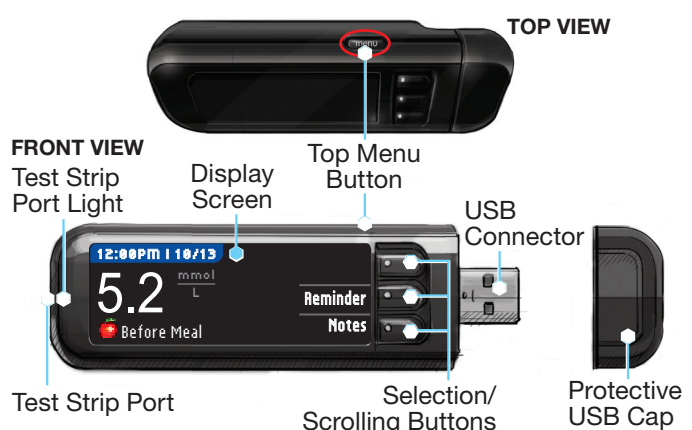

85683403 Rev. 01/17

Note: Check the units of measure of your meter. See your meter user guide for complete instructions.

Initial Setup of the Meter and Connection to Compatible Medtronic Device

Charging the Meter

- 1 Remove the USB cap to reveal the USB connector.**

The CONTOUR®NEXT LINK meter has a permanent rechargeable battery.

Charge your meter with the wall charger* or by plugging the USB connector into a computer. Be sure the computer is turned on.

Your meter will briefly display "Do Not Test-Charging" and the test strip port light will flash. **You cannot do a blood glucose test while the battery is charging.**

When charging is finished, the test strip port light will turn off. Unplug your CONTOUR NEXT LINK meter to test.



Unplug Meter From Charging Source Before Beginning Setup

- 2** To begin setup, hold down top Menu button for several seconds until the meter turns on.



- 3** Scroll down to select your language and press **OK**. Press **OK** if the correct language is displayed. Press **NO** if the incorrect language is displayed.

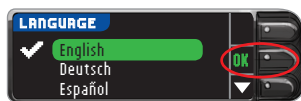

This meter screen image is an example for illustration purposes only.

- 4** Press **OK** to begin the connection process. **NOTE:** Pump refers to your compatible Medtronic device.

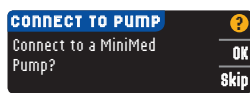

- 5 STOP. Do NOT press ANY buttons.** This screen displays the meter ID number (in the bottom left corner). This ID is needed to complete the connection process. Put down your meter. Pick up the compatible Medtronic device and continue with Step 6.

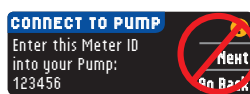

Connecting Meter to MiniMed Paradigm® Insulin Pump

- 6** Press **ACT** to go to the **MAIN MENU**. Scroll to **Utilities** by pressing the down arrow. Press **ACT**.



- 7** Scroll to **Connect Devices** and press **ACT**. Then scroll to **Meters** and press **ACT**. **Note:** If your **UTILITIES MENU** does not contain **Connect Devices**, scroll to **Meter Options** and press **ACT**.

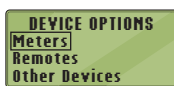

- 8** Select **On** and press **ACT**. If you are replacing a meter, go to **Step 9**. If you are adding a new meter, go to **Step 11**.



- 9** To replace a meter, select **Delete ID** and press **ACT**.



- 10** If you have multiple meter IDs, repeat Step 9 for each one.



? = Help

*Charger is available separately from Customer Service if not included in your meter kit. See contact information for Customer Service on opposite page.

- 11** To add a new meter, select **Add ID** and press **ACT**. Refer to Step 5 (or see meter back) to find meter ID (SN). Use the up and down arrow buttons to enter the six character meter ID shown on the meter screen. Press **ACT** after each character entry.



- 12** Select **Review ID** on your compatible Medtronic device to confirm that your CONTOUR®NEXT LINK meter ID has been correctly entered. If incorrect, go back to Step 9.



NOTE: For detailed instructions, see your compatible Medtronic device user guide.



- 13** Return to your CONTOUR NEXT LINK meter. After you have entered the meter ID into your compatible Medtronic device, press **Next**.

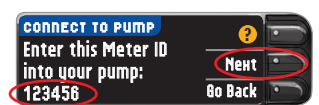

Choosing Meter Send Options

- 14 SEND OPTIONS** controls how your meter will send blood glucose readings to your compatible Medtronic device.

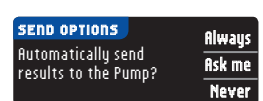

Choose the **SEND OPTION** that is best for you.

Always = Meter will always send results.

Ask Me = Meter will ask you before sending results.

Never = Meter will never send results.

Set Meter Date/Time to Match Medtronic Device

- 15** The date and time on your meter must match the date and time on your **Medtronic device**. Pick up **Medtronic device**.



Press **ACT** to go to the **MAIN MENU**. Scroll to **Utilities** and press **ACT**.

Scroll to **Time/Date** and press **ACT**. Select a time format and press **ACT**. Note the time and date. Return to your meter. Follow instructions on your meter to change the time and date to match your Medtronic device.

Additional Meter Settings

- 16** Press **Accept** to select **AutoLog is Off**. **AutoLog** allows you to mark a test result as **Fasting**, **Before Meal**, **After Meal**, or **No Mark**. See your user guide to learn more.

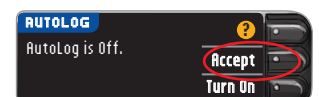

- 17** **Accept** or **Change** High and Low Alerts. The meter alerts you with a sound when your blood sugar level is above or below your set levels.



- 18** **Accept** or **Change** your Target range. The Target range is your goal for your blood sugar test results.



NOTE: Alerts can only be set outside your selected Target Range(s). Targets can only be set inside your selected Alert level(s). For additional information, you may contact Customer Service. Contact information for Customer Service is on the next page.

SETUP IS NOW COMPLETE!

Turn the page over to see testing instructions. →

ARTWORK ROUTING FOR APPROVAL

SCHAWKI	18211 NE 68th Street, E120 Redmond, WA 98052 T: 425-881-5454	Art Production
	DATE: March 30, 2017 CLIENT: Ascensia Diabetes Care DESCRIPTION: Contour Next Link mmol QRG - English	BAN#:85683403 Rev. 01/17 Contour Next Link mmol QRG - Canada Alt#1 - 03/09/17 copy changes Alt#2 - 03/24/17 copy changes Alt#3 - 03/30/17 Unmask
SCHAWK JOB#: 921897 SKU#: 9747 Parent BAN#:84612503 DIMENSIONS: 16.5" (H) x 8.0" (W) PRINTER SPEC: 10000752618 REV -	FONTS: Helvetica, Helvetica Neue, Zapf Dingbats, Arial, Skinny Mini, Mini Micra COLORS: Cyan Magenta Yellow Black 281 Process Build: 100C 79M 10Y 42K	
Clinical Trial/Global Master Template No: M-QRG-0298-R0005		
Regional Master Template No: M-GDE-QRG-0355-R0003		
NOTE: THIS COLOR PROOF INDICATES COLOR BREAK ONLY AND MAY NOT ACCURATELY REFLECT ACTUAL PRODUCTION COLOR.		
RELEASE: V-3 INTERNAL: R-X LANGUAGE(S): ENGLISH		

Materials for Testing



CONTOUR®NEXT
test strip



Lancing Device

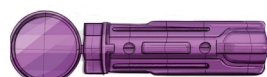

Lancet



CONTOUR®NEXT LINK
blood glucose meter

! WARNING:

- The lancing device is intended for self-testing by a single patient. It must not be used on more than one person due to the risk of infection.
- Use a new lancet each time you test because it is no longer sterile after use.
- All parts of the kit are considered biohazardous and can potentially transmit infectious diseases, even after you have performed cleaning and disinfection.
- Always wash your hands well with soap and water and dry them well before and after testing, handling the meter, lancing device, or test strips.

For complete instructions on cleaning and disinfecting your meter, please see your meter user guide.

Testing Your Blood

Obtaining the Blood Drop

- 1** From any screen, insert test strip and wait for **APPLY BLOOD** message.

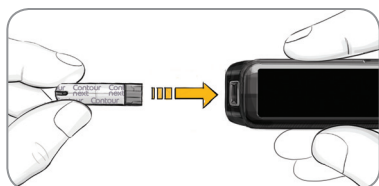

- 2** Remove lancing device endcap. Insert lancet firmly into lancing device until it comes to a full stop.

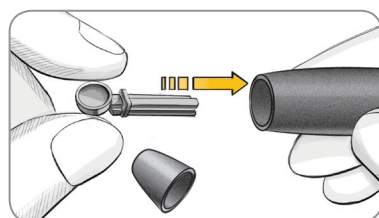

The lancing device graphics are for illustration purposes only. Your lancing device may look different. Refer to your lancing device insert for detailed instructions on preparing the lancing device.

- 3** Replace the endcap. Rotate the endcap dial to adjust the puncture depth.

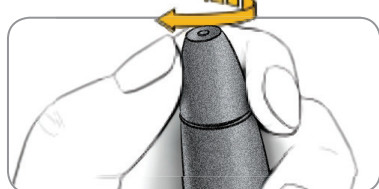

- 4** Obtain your blood drop.



Testing the Blood Drop

- 5** Touch the tip of the test strip to the drop of blood. If the first blood drop is not enough, the meter will beep twice and display **STRIP UNDERFILLED**. You have about 30 seconds to apply more blood to the same strip.
- 6** If AUTOLOG is on, you can choose to record your result as: **Fasting**, **Before Meal**, **After Meal** or **No Mark** for the test result.



NOTE: If your result is above your High Alert setting or below your Low Alert setting, you will see your result without having to make an AutoLog selection.

Sending Results to Your Compatible Medtronic Device

- 7** If **Always** was selected in **Send Options** during **Setup**, results will be sent directly to your pump. If **Ask Me** was selected in **Send Options** during **Setup**, you can choose to send your result to your pump after each blood sugar test.

Press **Send** or **Don't Send**.



Press **OK** to move to the next screen.



CAUTION: Always check the display on your pump to ensure that the glucose result shown agrees with the glucose result shown on the meter.

Reminder and Notes

- 8** Select **Reminder** to set a reminder for your next test. Select **Notes** to add more information to the result. Remove test strip.



Turn Meter Off

- 9** Remove the test strip and the meter will turn off in 3 minutes. Or hold down the Menu button to turn off the meter.



See your CONTOUR NEXT LINK user guide, lancing device insert and compatible Medtronic device user guide for full instructions.

For more information, go to www.diabetes.ascensia.com or contact Customer Service at: 1-800-268-7200

For information on patents, and related licenses, see: www.patents.ascensia.com

IVD For In Vitro Diagnostic Use

Manufactured for:
Ascensia Diabetes Care Holdings AG
Peter Merian-Strasse 90
4052 Basel, Switzerland

ASCENSIA
Diabetes Care

Medtronic

Ascensia, the Ascensia Diabetes Care logo, Clinilog, Contour, Glucofacts, and the No Coding logo are trademarks and/or registered trademarks of Ascensia Diabetes Care Holdings AG.

TM see www.ascensidiabetes.ca/en/tm-mc

Bolus Wizard, CareLink, Guardian, MiniMed, and Paradigm are trademarks and/or registered trademarks of Medtronic MiniMed, Inc.

© 2017 Ascensia Diabetes Care Holdings AG. All rights reserved.